



Rooftex 2C

Two Component Waterproofing Membrane

DESCRIPTION

Rooftex 2C is a cold applied two component, moisture curing, modified polyurethane elastomeric waterproofing membrane.

USES

The product can be used for waterproofing roof areas, wet areas, foundations and planters. It cures on exposure to atmosphere to a tough rubber-like seamless finish with excellent surface adhesion and elasticity.

ADVANTAGES

- Easily applied by brush, squeegee blade or airless spray
- Provides a uniform, joint free, seamless membrane
- UV Stable does not harden or become brittle
- Good oxidation stability
- Unaffected by rain soon after application
- Total adhesion to substrates
- Can be easily repaired if damaged

PHYSICAL PROPERTIES - TYPICAL

- | | |
|------------------------------------|---|
| • Tensile Strength | >2.1 N/mm ² |
| • Elongation | >750% |
| • Recovery (100% elongation) 24hrs | >94% |
| • Total solids | 90-95% |
| • Cure - Tack Free | approx. 24 hours |
| Through | approx. 48-72 hours |
| • Service strength | achieved after 7 days |
| • Specific Gravity | 1.2 (approx) |
| • Weatherometer | (BS3900) 1000hrs – loss of gloss – still pliable – no brittleness – no loss of general properties |

IMPORTANT NOTE

Information published is based on a final report issued by a UK Independent Test Laboratory.

Test Report Reference: N950/TR0042 dated 11/11/2015.

A copy of the report is available on request.

TEMPERATURE

Rooftex 2C should not be applied if the substrate temperature is below 10°C or above 40°C.

INSTRUCTIONS FOR USE

SURFACE PREPARATION

All surfaces to be treated should be clean, dry and sound. Concrete/cementitious screeds should be fully cured. Special primers are available and recommended in certain conditions; refer to Conren's Technical Department.

MIXING
 The entire contents of Rooftex 2C Part A and Part B should be combined and thoroughly blended using a mixing drill fitted with a paddle to ensure complete dispersion.

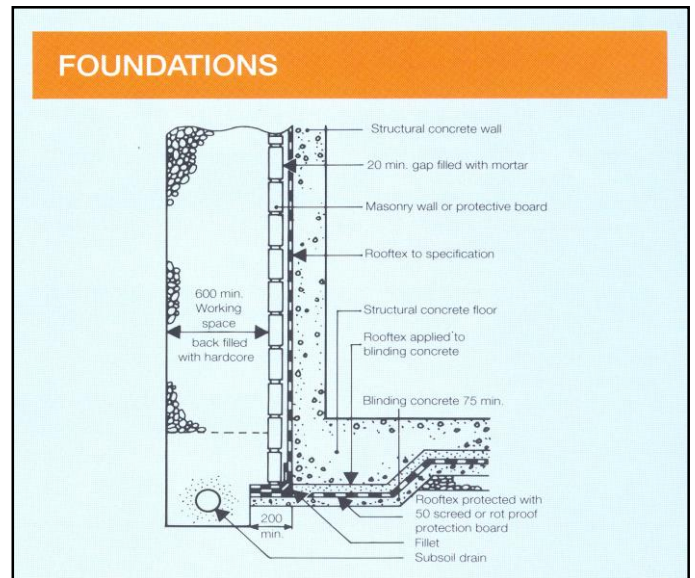
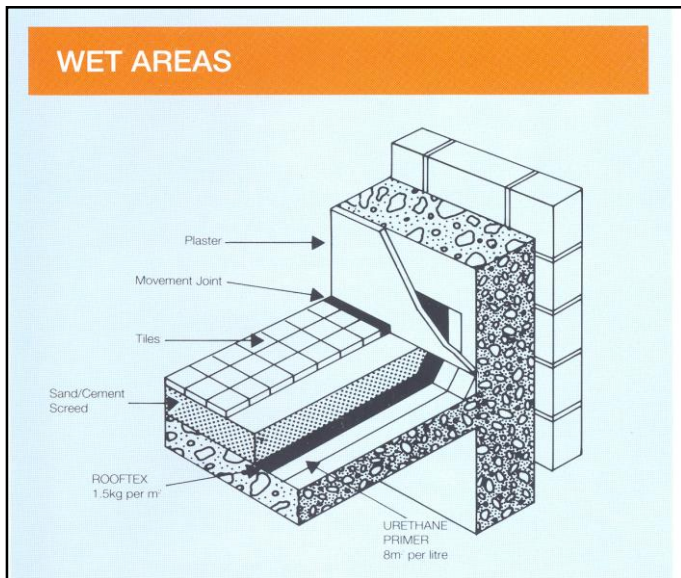
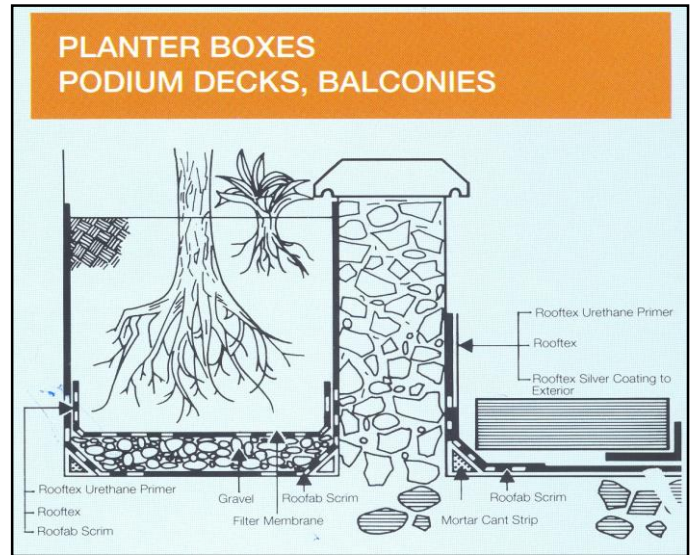
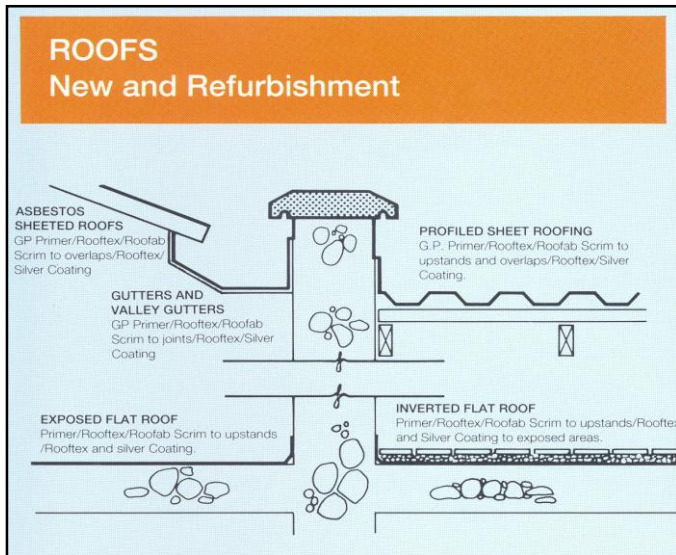

STORAGE
 Shelf life at least 12 months if stored in original containers between 10° C and 25° C and away from direct sunlight.

Technical Service and Quality Assurance

All information provided in this leaflet is based on results obtained from our own experience and testing which is given in good faith. The information is provided without guarantee as the user will be deemed to have satisfied themselves independently of the suitability of Conren's product for their own particular purpose. Conren Limited cannot be held responsible for any errors as a result of any incorrect information being provided.



www.conren.com

Conren Limited. Unit 1, The Bridge Business Centre,
 Ash Road South, Wrexham Industrial Estate,
 Wrexham. LL13 9UG

Tel: +44 (0) 1978 661 991
 Fax: + 44 (0) 1978 664 664
 E-mail: info@conren.com