



Rooftex PF

One Component Waterproofing Membrane

DESCRIPTION

RoofTex PF is a cold applied one component, pitch free, moisture curing, modified polyurethane elastomeric membrane applications.

USES

The product can be used for waterproofing roof areas, wet areas, foundations and planters. It cures on exposure to atmosphere to a tough rubber-like seamless finish with excellent surface adhesion and elasticity.

ADVANTAGES

- Easily applied by brush, squeegee blade or airless spray
- Provides a uniform, joint free, seamless membrane
- UV Stable does not harden or become brittle
- Good oxidation stability
- Unaffected by rain soon after application
- Total adhesion to substrates
- Can be easily repaired if damaged

PHYSICAL PROPERTIES – TYPICAL

• Tensile Strength	1.6 N/mm ²
• Elongation	200%
• Recovery (100% elongation) 24hrs	100%
• Total solids	90-95%
• Cure - Tack Free	approx. 24 hours
• Through	approx. 48-72 hours
• Service strength	achieved after 7 days
• Specific Gravity	1.13

Weatherometer - (BS3900) 1000hrs /loss of gloss/still pliable no brittleness/no loss of general properties

COVERAGE AND PACK SIZES

Material	Pack Size (Kg/Ltr)	Coverage
RoofTex PF	21kg	1.5-2kgm ² (2 coats)

COLOURS

RoofTex PF is available in black. Alternatively it can be treated with RoofTex Granules or RoofTex Silver Coating for heat and light reflectivity when used in exposed applications.

TEMPERATURE

RoofTex PF should not be applied at temperatures below 10°C and above 35°C

INSTRUCTIONS FOR USE

SURFACE PREPARATION

All surfaces to be treated should be clean, dry and sound. Concrete/cementitious screeds should be fully cured. Special primers are available and recommended for use over existing membranes, porous/weak concrete, cementitious screeds and asbestos sheets prior to application of RoofTex PF waterproofing membrane.

COMPLEMENTARY PRODUCTS

Rooftex Urethane Primer

Rooftex GP Primer

Roofab Scrim

- for use with new concrete, cementitious screeds etc
- specially formulated for use with bituminous, asphalt surfaces, old or failed membranes, metal, glass and timber.
- designed to reinforce Rooftex PF for use on upstand joints, complete coverage of old, failed roofing systems, reinforcing joints .

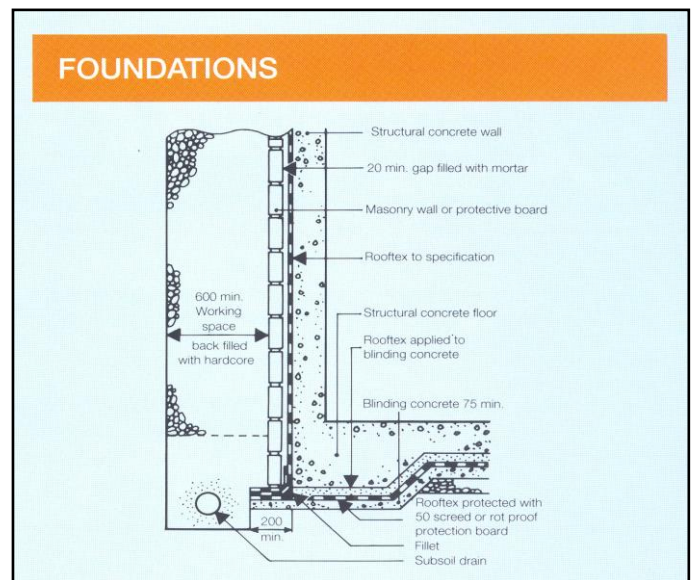
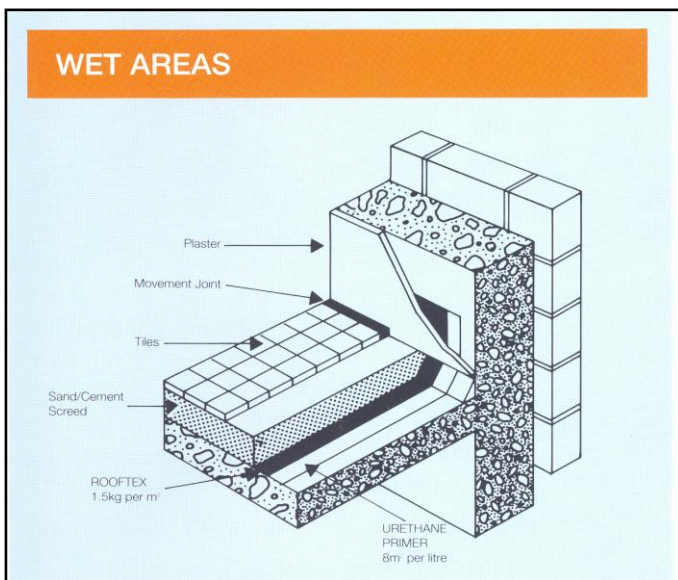
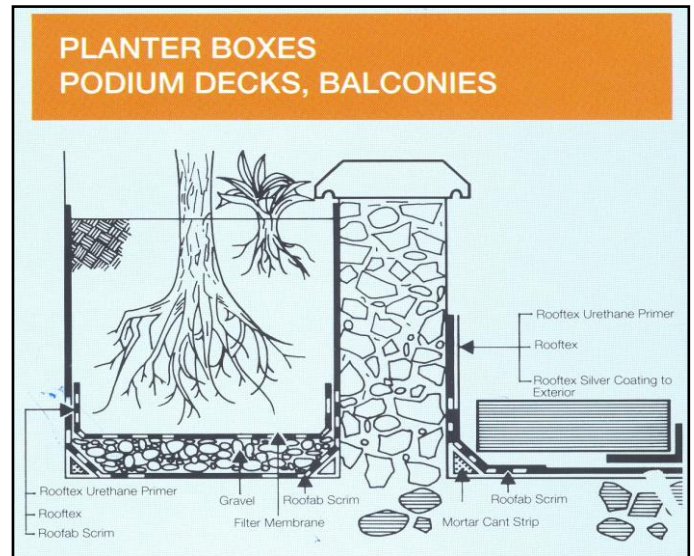
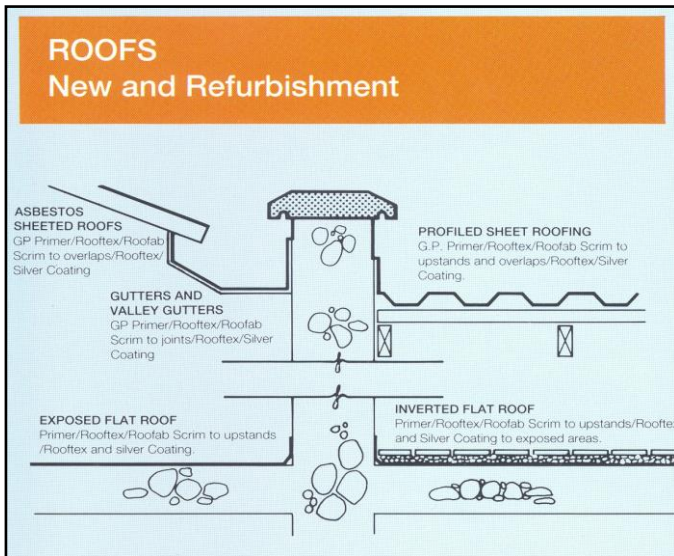

STORAGE

Shelf life at least 12 months if stored in original containers between 10° C and 25° C and away from direct sunlight.

Technical Service and Quality Assurance

All information provided in this leaflet is based on results obtained from our own experience and testing which is given in good faith. The information is provided without guarantee as the user will be deemed to have satisfied themselves independently of the suitability of Conren's product for their own particular purpose. Conren Limited cannot be held responsible for any errors as a result of any incorrect information being provided.



www.conren.com

Conren Limited. Unit 1, The Bridge Business Centre,
Ash Road South, Wrexham Industrial Estate,
Wrexham. LL13 9UG

Tel: +44 (0) 1978 661 991
Fax: + 44 (0) 1978 664 664
E-mail: info@conren.com