



Rooftex

One Component Waterproofing Membrane

DESCRIPTION

Rooftex is a cold applied one component, moisture curing, modified polyurethane elastomeric waterproofing membrane.

USES

The product can be used for waterproofing roof areas, wet areas, foundations and planters. It cures on exposure to atmosphere to a tough rubber-like seamless finish with excellent surface adhesion and elasticity.

ADVANTAGES

- Easily applied by brush, squeegee blade or airless spray
- Provides a uniform, joint free, seamless membrane
- UV Stable does not harden or become brittle
- Good oxidation stability
- Unaffected by rain soon after application
- Total adhesion to substrates
- Can be easily repaired if damaged

PHYSICAL PROPERTIES – TYPICAL

• Tensile Strength	1.6 N/mm ²
• Elongation	Approx. 500%
• Recovery (100% elongation) 24hrs	>94%
• Total solids	90-95%
• Cure - Tack Free	approx. 24 hours
• Through	approx. 48-72 hours
• Service strength	achieved after 7 days
• Specific Gravity	1.3 (approx)
• Weatherometer	(BS3900) 1000hrs – loss of gloss – still pliable – no brittleness – no loss of general properties

IMPORTANT NOTE

The results shown are typical and are based on a sample taken from a randomly selected production batch. Whilst we expect to achieve these results, during manufacture we would allow a tolerance of +/- 20%. However, information published in a report issued by a UK Independent Test Laboratory (Test Report Reference: N950/TR0042 dated 11/11/2015) has recorded results up to 750% elongation. A copy of the report is available on request.

TEMPERATURE

Rooftex should not be applied if the substrate temperature is below 10°C or above 40°C.

INSTRUCTIONS FOR USE

SURFACE PREPARATION

All surfaces to be treated should be clean, dry and sound. Concrete/cementitious screeds should be fully cured. Special primers are available and recommended in certain conditions; refer to Conren's Technical Department.

COMPLIMENTARY PRODUCTS

- Rooftex Silver Coating** – used to overcoat cured Rooftex and offers extra heat/light stability.
- Rooftex Urethane Primer** – for use with new concrete, cementitious screeds.
- Rooftex GP Primer** – specially formulated for use with bituminous, asphalt surfaces, old or failed membranes, metal, glass and timber.
- Roofab Scrim** – designed to reinforce Rooftex for use on upstand joints, complete coverage of old, failed roofing systems, reinforcing joints on timber decking etc.

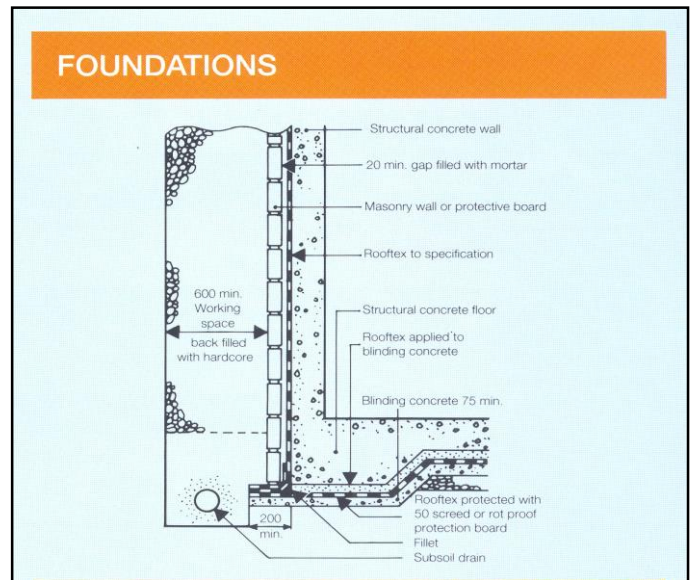
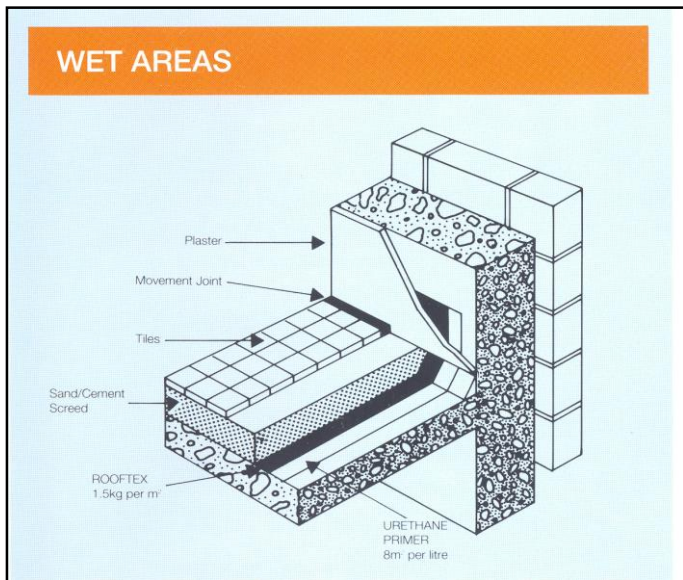
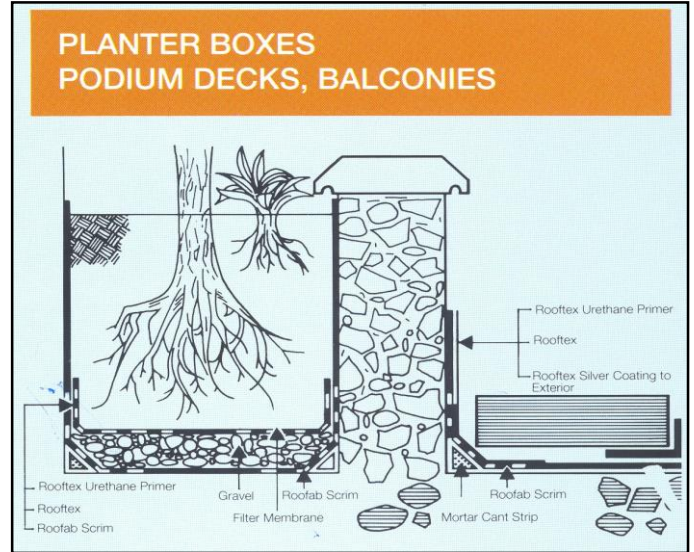
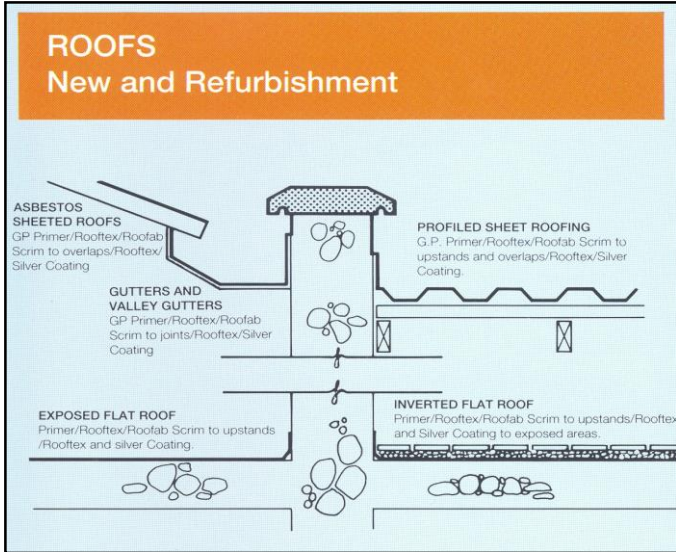

STORAGE

Shelf life at least 12 months if stored in original containers between 10° C and 25° C and away from direct sunlight.

Technical Service and Quality Assurance

All information provided in this leaflet is based on results obtained from our own experience and testing which is given in good faith. The information is provided without guarantee as the user will be deemed to have satisfied themselves independently of the suitability of Conren's product for their own particular purpose. Conren Limited cannot be held responsible for any errors as a result of any incorrect information being provided.



www.conren.com

Conren Limited. Unit 1, The Bridge Business Centre,
Ash Road South, Wrexham Industrial Estate,
Wrexham. LL13 9UG

Tel: +44 (0) 1978 661 991
Fax: + 44 (0) 1978 664 664
E-mail: info@conren.com